



OLD LIGHTHOUSE ESTATE
LOTS, WHERE THE ONLY LIMIT
IS YOUR IMAGINATION

DISCOVER A NEW HORIZON OF LIVING

Experience the pinnacle of refined living at Rosewood Residences Estate Lots, nestled within the most coveted addresses of the Estates enclave. Each lot offers expansive ocean views that stretch endlessly, where the Pacific Ocean meets the Sea of Cortez, framed by the majestic granite cliffs of this exclusive retreat.

Here, every sunrise and sunset transforms the sky into a breathtaking canvas, evoking a sense of wonder each day. Immerse yourself in the tranquility and inspiration these unparalleled views provide, where the timeless elegance of Rosewood Residences seamlessly harmonizes with the natural splendor of Los Cabos.





CRAFT YOUR VISION OF LIVING

At Rosewood Residences Estate Lots, you are invited to embrace the freedom to create the home of your dreams within an extraordinary and breathtaking setting. Whether you choose to collaborate with your own architects, guided by our elevated design principles, or entrust us to curate every aspect of the design and build process, your vision will come to life in the stunning beauty of Old Lighthouse. Revel in the joy of crafting a personalized sanctuary that effortlessly harmonizes with the natural landscape, offering unmatched luxury and comfort. Here, every detail is thoughtfully designed to enhance your lifestyle, every day.









Rosewood Residences Estate Lots offer the most expansive ocean views in Los Cabos, elevated more than 300 feet above sea level. With starting sizes of 24,000 square feet and an average of 120 feet of ocean view frontage, they are among the most generous available, providing ample space to thoughtfully design a home that fulfills your every desire. The over 30-foot height differential between rows ensures that each lot enjoys unobstructed, panoramic ocean vistas, effortlessly overlooking neighboring residences.



ESTATE LOT: 64

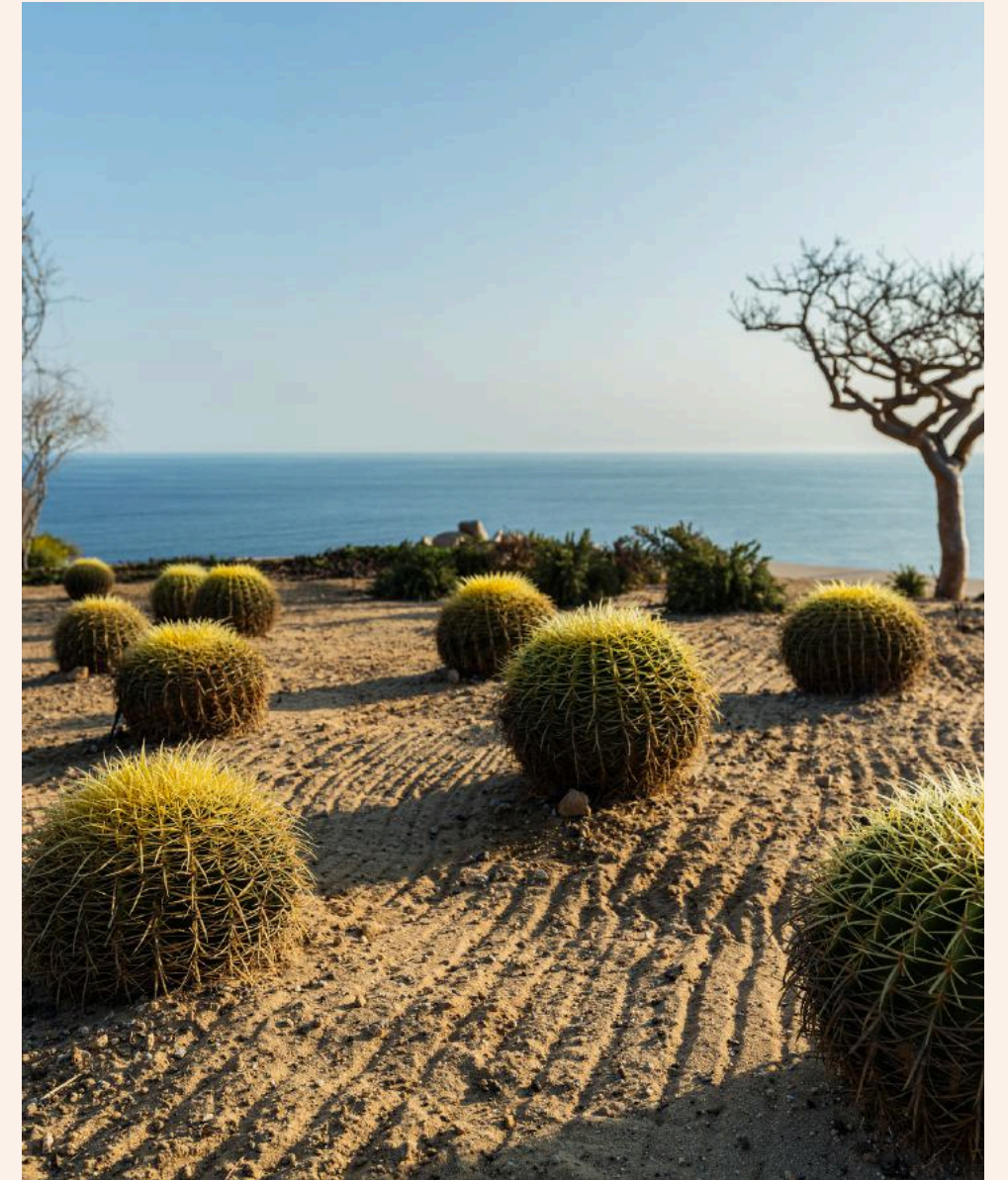
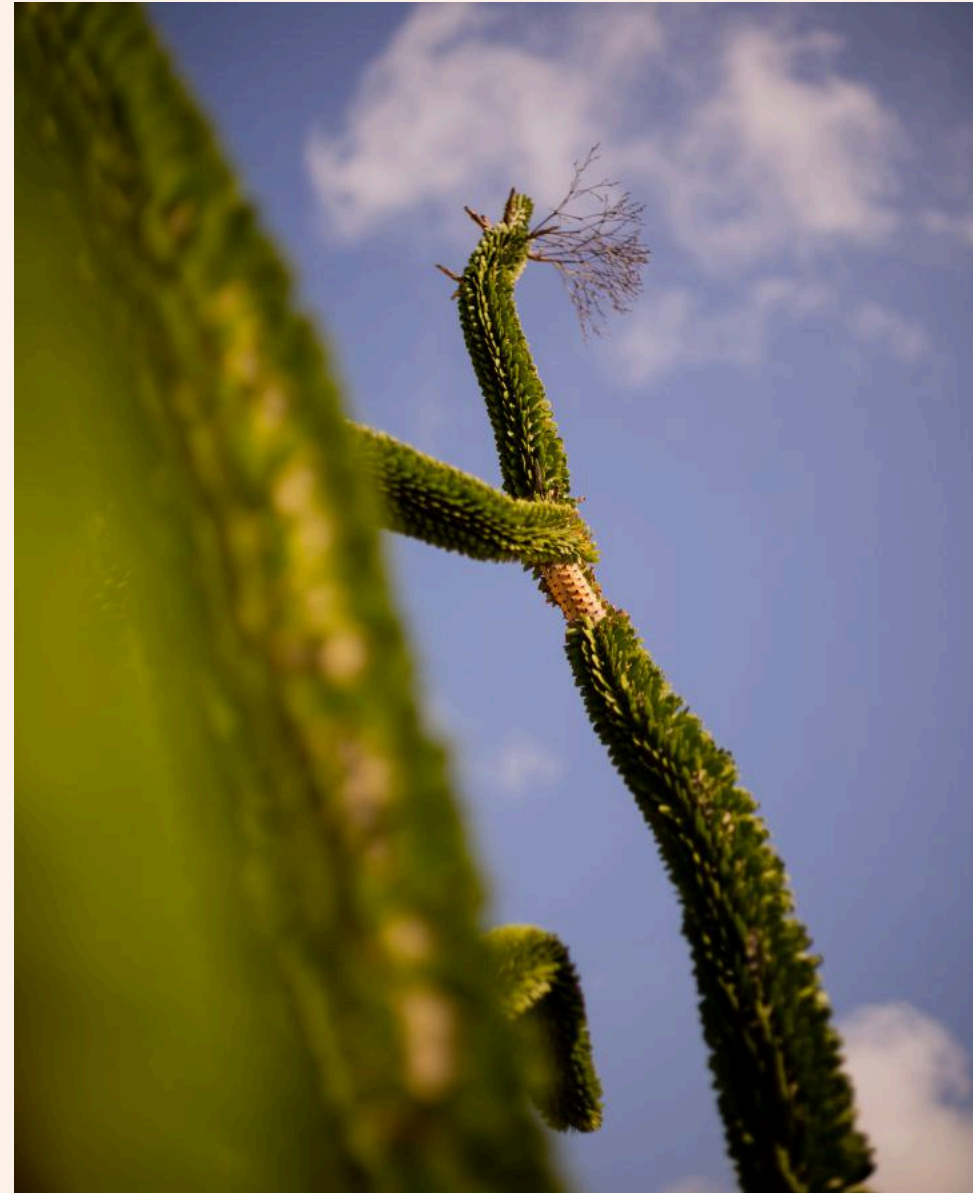
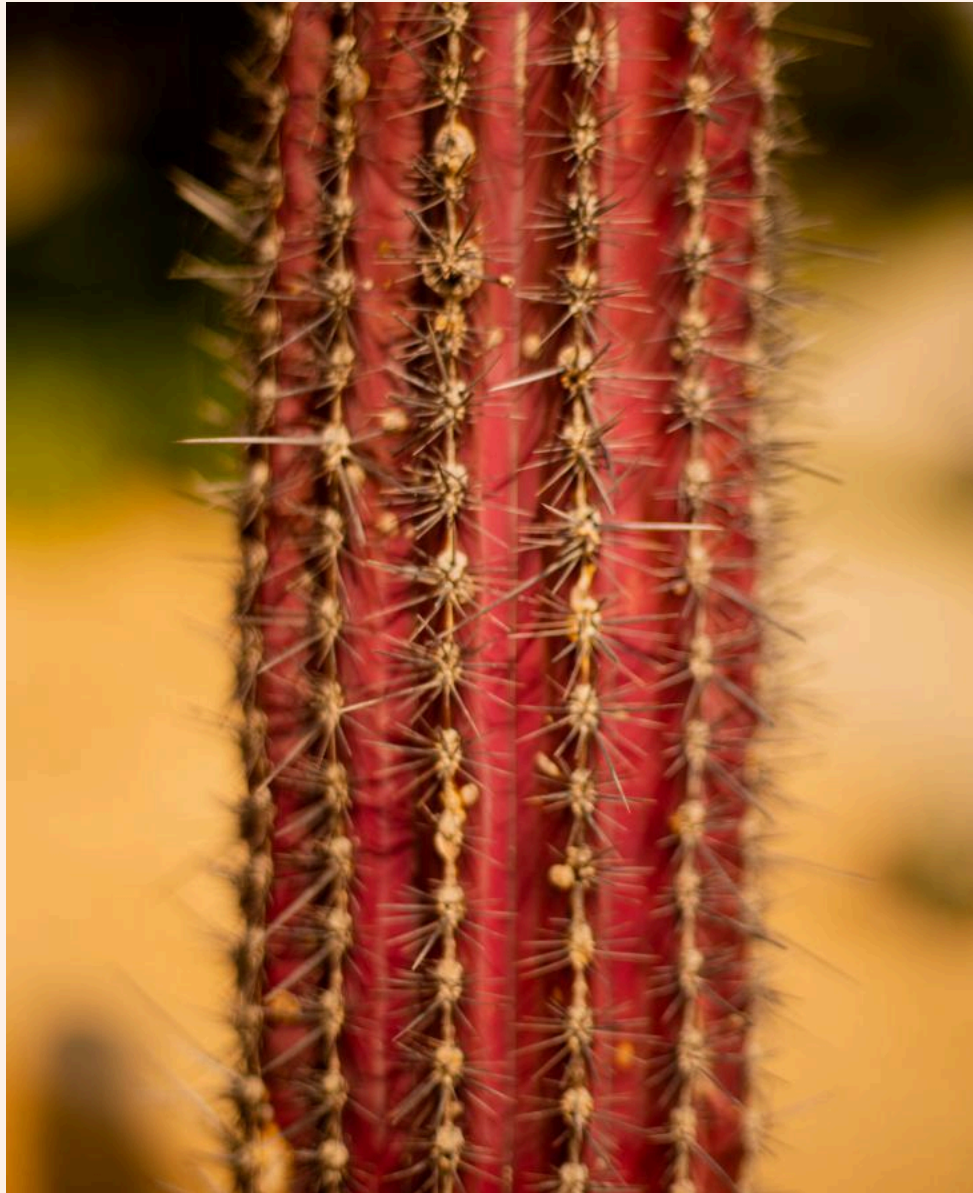

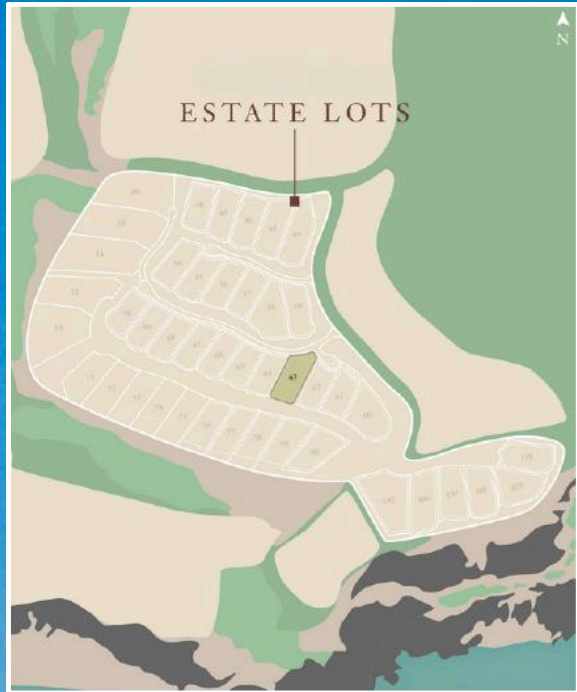







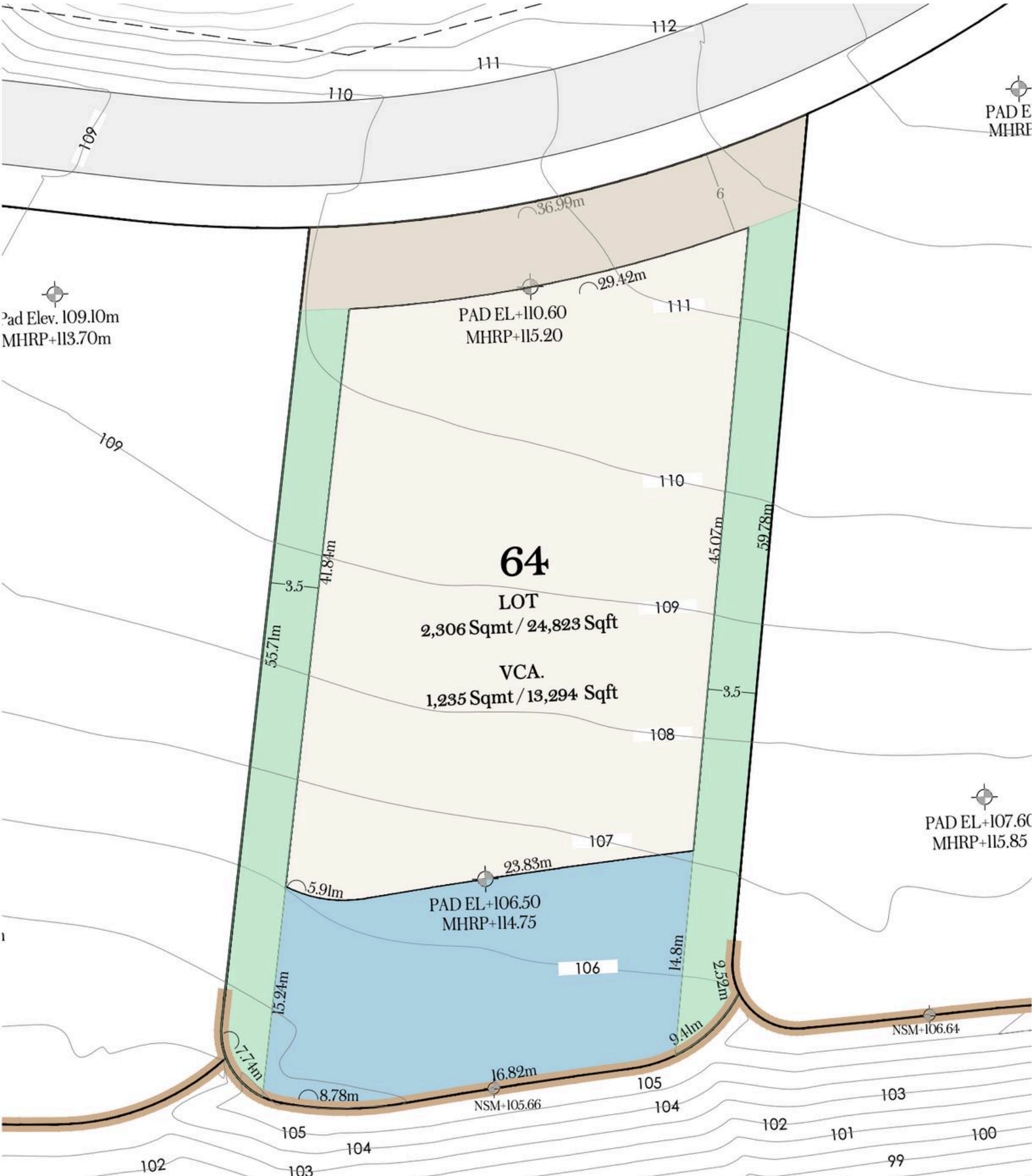



ESTATE LOT 64 VIEW

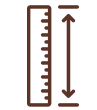

LOT 64 SPECIFICATIONS



	Homesite Area	0.57 Acres
	Vertical Construction Area	13,294 SQ/FT
	Ocean Frontage	127.49 FT
	Max Build Height, MHRP	Refer to Elevation Map

-  Front Setback
-  Vertical Construction Area (VCA)
-  NON-Vertical Construction Area (NVCA)
-  Side Setback, VCA
-  Retaining walls
-  Topographic Contours

Please review the Old Lighthouse Design Guidelines as a resource for the site planning, landscape, and architectural design of your homesite.

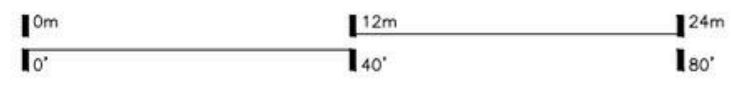

1:500 @ 8.5 x 11"

August 2024

Disclaimer: This material is not an offer to sell or solicitate to purchase property to any resident ora state or country, where registration is required prior to such offer or solicitation, and is void where prohibited by law. The plan reflects the intention of the Developer; Grand Arnee Del Cabo, Sa De CV Reserves the right to make any changes without prior notice and to modify the renderings, floor plans, amenities and all services.



